

FirstView[®] Self-Guided Tools

**Registering with
your Student ID**



FirstView®
Self-Guided Tools



Step 1:
Download app, Register,
& Log-in.



FirstView® Self-Guided Tools

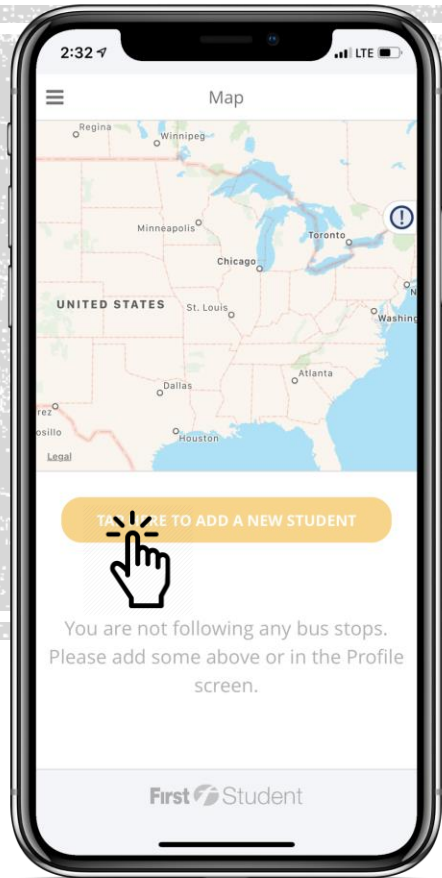

Step 2:
Click the yellow message box to add your first student, or you can click profile and “Add a Student” in the app menu.



FirstView® Self-Guided Tools

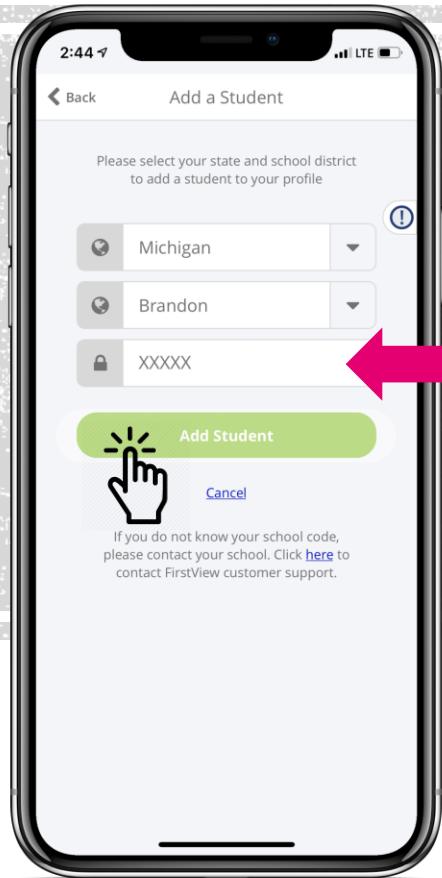

Step 3:
Select your state and school district from the drop-down. Add your student ID.* Click 'Add Student'.



* If you do not know your student ID, please contact your school district.



Your student is added!



FirstView® Self-Guided Tools

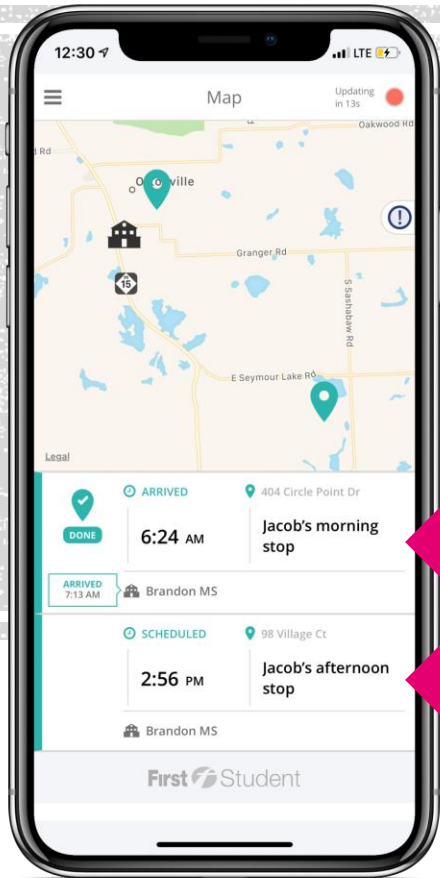

Step 11:
Your student's stop
information is now
displayed on the map for
tracking.



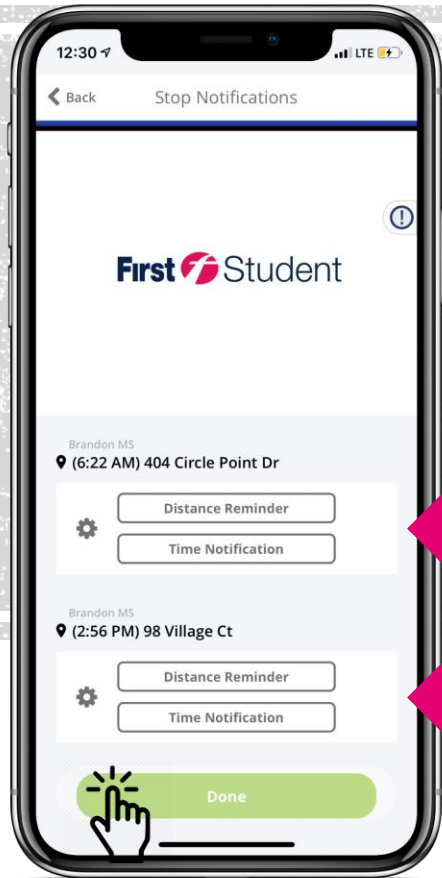

Setting Up Alerts:
Setup optional alerts for your student's routes. These can be added from the profile section and selecting your student's name under "Student Stops".



**Thank You for
being a FirstView
Customer!**

